

AC-BOX ATEX

VENTILATOR SA UNAZAD ZAKRIVLJENIM LOPATICAMA U EKSPLOZIVNOJ ATMOSFERI G ILI D GRUPA II 2 ILI 3

CABINET BACKWARD CURVED BLADE FAN
IN EXPLOSIVE ATMOSPHERE G OR D
GROUP II CATEGORY 2 OR 3



APLIKACIJE

AC-BOX ATEX linija je dizajnirana za instalacije gde je potrebno garantovati pravilno usisavanje vazduha, izbegavajući rizik od eksplozije usled zapaljivog gasa. Na primer, prostorije za baterije, hemijske prostorije, laboratorije itd.

DOMET

Asortiman se sastoji od 8 veličina sa impelerom od 350 do 800 mm i protokom vazduha do skoro 20.000 m³/h. Maksimalni pritisci su dozvoljeni do 1.000 Pa.

KARAKTERISTIKE

AC-BOX ATEX liniju karakterišu posebni materijali i dizajn kako bi se što više izbegao rizik od eksplozije, u skladu sa ATEX direktivom ATEX 2014/34/UE. Različite konstrukcije su predviđene za ventilatore u kategoriji 2G, 2D ili 3G, 3D.

KONSTRUKCIJA

- Glavni okvir od aluminijumskog profila sa zaptivkama za zatezanje.
- Uklonjive dvoslojne ploče od pocinkovanog čeličnog lima, debljine 25 mm, iznutra obložene akustičnim materijalom, savitljivim, samogasivim, klase 1.
- Prednja ploča sa kružnim bakarnim ulaznim delom, bez unutrašnje obloge.
- Izlazna bočna ploča bez unutrašnje obloge, opremljena kablovskom uvodnicom i slobodnim kablom od 0,5 m za električno povezivanje i montažu kanala.
- Visokoefikasno radno kolo sa unazad zakrivljenim lopaticama od pocinkovanog čeličnog lima. Balansiranje prema UNI ISO 21940-11.
- Asinhroni trofazni ili monofazni elektromotor, van protoka vazduha, zaštita IP 55, klasa izolacije F, S1 servis, konstrukcija prema IEC / EEC / UNEL MEC.
- Otporan na eksploziju, ATEX ODOBRENO ZA EKSPLOZIVNE ATMOSFERE - RE G ili D GRUPA II.
- Raspored 4 (direktno spajanje).

TEHNIČKE SPECIFIKACIJE

- Transportovana tečnost: gasovi bez prašine, nisu abrazivni niti korozivni.
- Temperatura transportovanog vazduha: -20°C / +40°C
- Napajanje:
 - Trofazna verzija (T) 400V-50Hz.
 - Monofazna verzija (M) 230V-50Hz
- Usisni bočni panel je zatvoren.

PRIBOR

- Vodootporni poklopac (RC-CB).
- Nosači za fiksiranje (FB-CB) uključeni su uz model 800..
- Nožice (SF-CB).
- Kružna kontra-prirubnica (CF-DU).
- Fleksibilni priključci (FC-DU-Ex), poliester prema EN 13463-1.
- Zaštita usisnika (FPG).
(Obavezno za upotrebu u otvorenom vazduhu).
- Spoljna razvodna kutija ATEX (OTB-ATEX)
- Servisni prekidač ATEX (SW-ATEX).

APPLICATIONS

AC-BOX ATEX line has been designed for installations where it is necessary to guarantee the correct air extraction avoiding risks of explosion due to flammable gas. For instance, battery rooms, chemical premises, laboratories etc..

RANGE

This line consists of 8 sizes with impeller diameter from 350 to 800 mm and airflow up to almost 20.000 m³/h. Maximum pressures allowed up to 1000Pa.

ADVANTAGES

AC-BOX ATEX line is characterized by particular materials and design to avoid as much as possible the risk of explosion, according to ATEX directive ATEX 2014/34/UE. Different constructions are foreseen for fans in category 2G, 2D or 3G, 3D.

CONSTRUCTION

- Main frame in aluminium profile with tightening gaskets.
- Removable double skin galvanized steel sheet panels, 25 mm thick, inside lined with acoustic material convoluted self-extinguishing cl.1.
- Front panel with circular copper inlet section, without inner lining.
- Outlet side panel without inner lining, fitted with cable gland and loose cable 0,5 m for electrical connection and ducting installation.
- High efficiency backward curved blade impeller in galvanized steel sheet. Balancing according to UNI ISO 21940-11.
- Asynchronous three-phase or mono-phase electric motor, outside the airflow, protection IP 55, insulation class F, S1 service, construction according to IEC / EEC / UNEL MEC.
- Explosion proof ATEX APPROVED FOR EXPLOSIVE ATMOSPHERE G or D GROUP II.
- Arrangement 4 (direct coupling).

TECHNICAL SPECIFICATIONS

- Conveyed fluid: non dusty gases, not abrasive nor corrosive.
- Temperature of conveyed fluid: -20°C/+40°C.
- Voltage and frequency: Three phase version (T) 400V-50Hz. Mono-phase version (M) 230V-50Hz.
- Inlet side panel closed.

ACCESSORIES

- Weatherproof cover (RC-CB).
- Fixing brackets (FB-CB) included with 800 model.
- Support feet (SF-CB).
- Circular counter-flange (CF-DU).
- Flexible connections (FC-DU-Ex), polyester according EN 13463-1.
- Inlet guard (FPG). (Mandatory for use in free air).
- External terminal box ATEX (OTB-ATEX)
- Service switch ATEX (SW-ATEX).

AC-BOX ATEX

PERFORMANSE - PERFORMANCES

Performanse prikazane na dijagramima odnose se na vazduh na temperaturi od 15 ° C i nadmorskoj visini od 0 m. , a dobijeni su u instalacijama tipa "C" u nedostatku mreže i pribora.

Performances shown in the selection diagrams refer to air at 15°C temperature and 0 mt a.s.l. altitude, and they were obtained in installation type "C" with no grid nor accessories.

4 POLA / POLES (1500 RPM) MONOFAZNO / SINGLE-PHASE (1Ph-230V 50Hz)

Model Model	Pm (kW)	In max (A)	Mot. (H)	Lp (dB(A))
354 M	0,25	2,4	71	49
404 M	0,37	3,1	71	51
454 M	0,75	5,6	80	55

4 POLA / POLES (1500 RPM) TROFAZNO / THREE-PHASE (3Ph-400V 50Hz)

Model Model	Pm (kW)	In max (A)	Mot. (H)	Lp (dB(A))
354 T	0,25	0,8	71	49
404 T	0,37	1,2	71	51
454 T	0,75	2,0	80	55
504 T	1,1	2,8	90	58
554 T	1,5	3,5	90	61
604 T	3	6,5	100	67

6 POLA / POLES (1000 RPM) TROFAZNO / THREE-PHASE (3Ph-400V 50Hz)

Model Model	Pm (kW)	In max (A)	Mot. (H)	Lp (dB(A))
456 T	0,37	1,3	80	46
506 T	0,37	1,3	80	49
566 T	0,75	2	90	51
636 T	1,1	3	90	57
716 T	2,2	5	112	61
806 T	3	6,8	132	67

Pm = Snaga motora
In = Potrošnja struje
Lp = Nivo zvučnog pritiska u slobodnom polju na 3 m od ventilatora sa kanalnim otvorima.

Pm = Motor power. In = Absorbed current. Lp = Sound pressure level is measured in free field at 3 m distance from the fan, with inlet and outlet ducted.

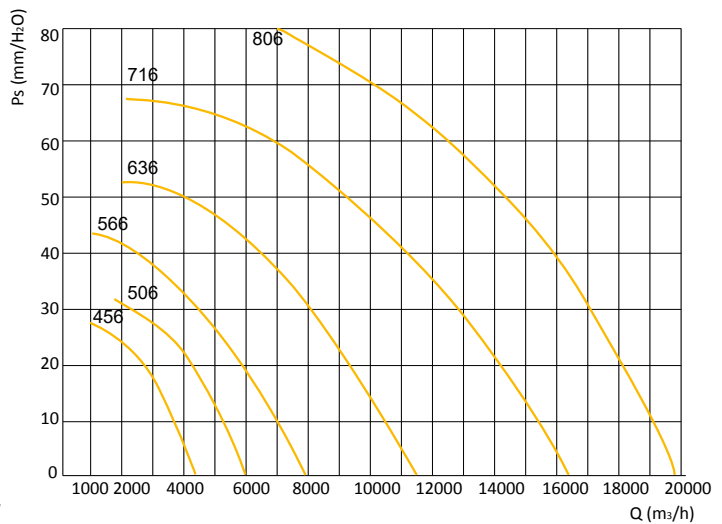
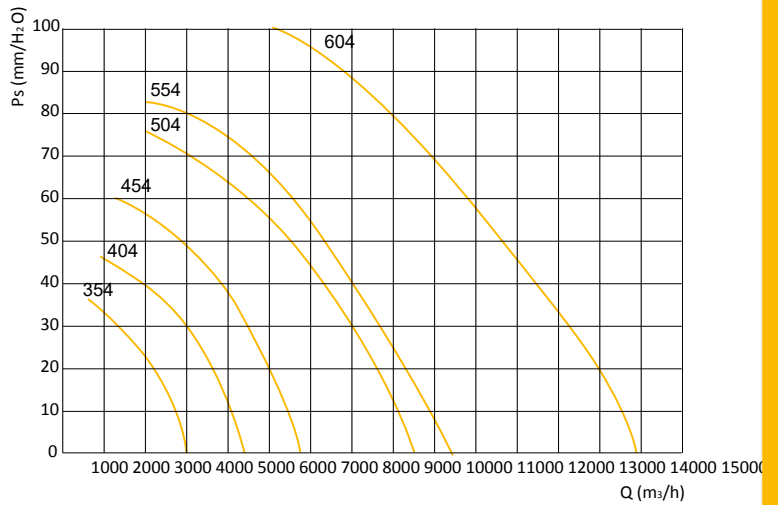

Tolerancije: aerodinamičke performanse i buka su unutar tolerancije navedene u DIN 24166, klasa 2.

TOLERANCES: performances and sound power levels within the tolerances allowed by the DIN 24166 standard for Class 2.

AC-BOX ATEX

NAČIN INSTALACIJE - INSTALLATION METHOD

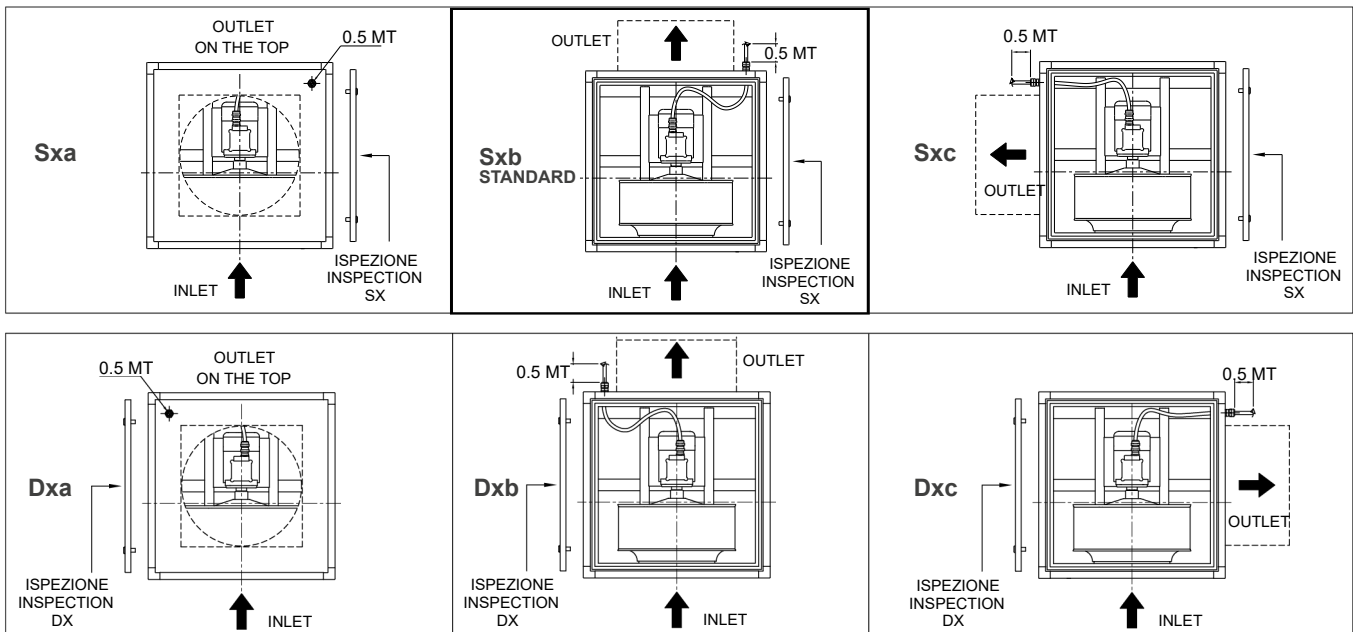

AC-BOX ATEX

DIMENZIJE - DIMENSIONS

Model Model	A	∅B	∅C	kg
350	550	550	300	40
400	700	700	350	60
450	700	700	400	80
500	800	800	450	100
550	800	800	450	130
560	800	800	500	120
600	1000	1000	500	140
630	1000	1000	550	160
710	1000	1000	600	170
800	1100	1100	700	200

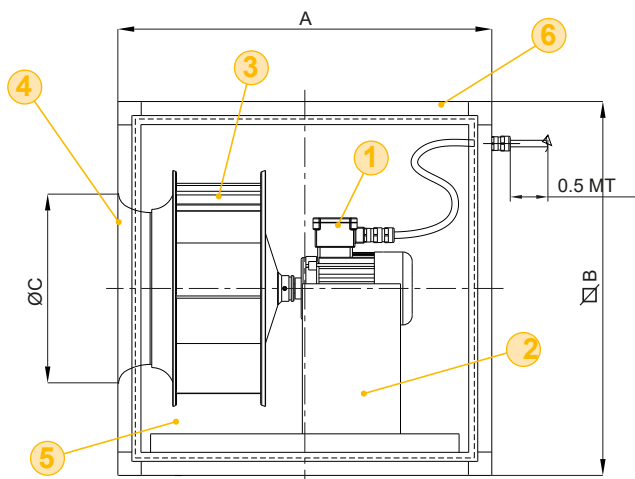

- 1 MOTOR - Motor
- 2 NOSAČ MOTORA - Motor support
- 3 IMPER - Impeller
- 4 ULAZNI KONUS - Inlet cone
- 5 INSPEKCIJSKA TABLA - Inspection panel
- 6 OKVIR - Frame

AC-BOX ATEX

PRIBOR - ACCESSORIES

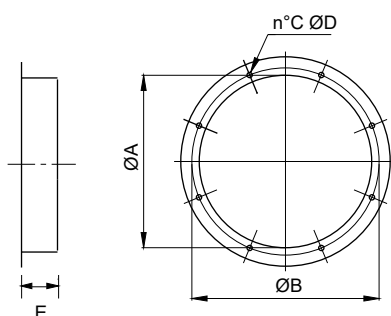
CF-DU: KONTRAPRIRUBNICA
COUNTER FLANGE

Model Model	AC-BOX ATEX	∅A	∅B	C	∅D	E	kg
CF-DU 35	350	360	395	8	10	80	1,2
CF-DU 40	400	410	450	8	12	80	1,9
CF-DU 45	450	460	500	8	12	80	2,1
CF-DU 50	500/550	510	560	12	12	80	2,4
CF-DU 56	560/600	570	620	12	12	80	2,6
CF-DU 63	630	640	690	12	12	80	2,9
CF-DU 71	710	710	770	16	12	80	3,4
CF-DU 80	800	810	860	16	12	80	3,9

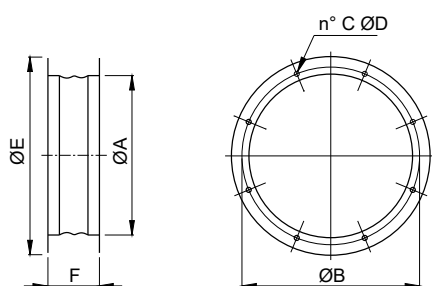
FC-DU-EX: FLEKSIBILNA VEZA
FLEX CONNECTION

Dizajniran da spreči širenje vibracija duž kanala.

Designed to prevent the propagation of the vibrations along the duct.

Model Model	AC-BOX ATEX	∅A	∅B	C	∅D	∅E	F	kg
FC-DU-EX 35	350	360	395	8	10	466	200	2,6
FC-DU-EX 40	400	410	450	8	12	496	200	4
FC-DU-EX 45	450	460	500	8	12	546	200	4,5
FC-DU-EX 50	500/550	510	560	12	12	598	200	5,2
FC-DU-EX 56	560/600	570	620	12	12	658	200	5,5
FC-DU-EX 63	630	640	690	12	12	730	200	6,2
FC-DU-EX 71	710	710	770	16	12	810	200	7,2
FC-DU-EX 80	800	810	860	16	12	910	200	8,3

FB-CB:
FIKSIRANJE ZASTAVA
FIXING BRACKETES

Nožice omogućavaju fiksiranje ventilatora. Komplet se sastoji od 4 dela pocinkovanog čeličnog lima, za fiksiranje na samonoseći okvir BOX-a. Uključeno uz model 800.

The feet allow the fixing of the fan. Kit composed by 4 pieces in galvanized steel sheet, to be fixed to the BOX self-carrying frame. Included with 800 model.

