

# PLATE-S

## AKSIJALNI PANEL VENTILATOR SA "KOMPAKTNIM" MOTOROM

PLATE MOUNTED AXIAL FAN WITH "COMPACT MOTOR"



### APLIKACIJE

PLATE-S linija je idealna kada su potrebni veliki kapaciteti sa niskim pritiscima, u aplikacijama za pričvršćivanje na zid ili panele: na primer: ventilacija industrijskih i komercijalnih zgrada, parkinga, stočnih farmi, ili u hlađenju električne i rashladne opreme, itd.

### DOMET

Ova linija se sastoji od 8 veličina sa prečnikom radnog kola od 300 do 700 mm.

### GLAVNE KARAKTERISTIKE

Glavne karakteristike PLATE-S linije su: ekstremna kompaktnost, zbog smanjene izbočine elektromotora; savršeno podešavanje brzine, uz smanjenu buku (električno brujanje) i potrošnju struje. Ove prednosti su zbog kompaktnog motora (bez ventilatora za hlađenje) dizajniranog da se koristi isključivo u aksijalnim ventilatorima.

### KONSTRUKCIJA

- Noseći okvir sa širokim ulazom u obliku materijala otpornog na koroziju ili zaštićen od atmosferskih uticaja.
- Nosač motora i sigurnosna rešetka, u čeličnoj šipki, proizvedena u skladu sa UNI EN ISO 12499.
- Lopatice aeroprofila visoke efikasnosti od plastičnog materijala i glavčina od livene aluminijumske legure. Promenljivi ugao nagiba.
- Balansiranje prema UNI ISO 21940-11.
- Asinhroni elektromotor trofazni ili jednofazni sa termičkom zaštitom, podesiva brzina, zaštita IP 55, klasa F izolovana, servis S1.
- Raspored 5 (propeler direktno povezan sa vratilom motora).

### TEHNIČKE SPECIFIKACIJE

PLATE-S standard

- Vazduh koji se prenosi: čist, ne abrazivan.
- Temperatura transportovanog
- vazduha: -20 °C / + 50 °C
- Napon:
- trofazna verzija (T) 400V-3Ph.
- monofazna verzija (M) 230V-1Ph.
- Frekvencija: 50Hz.
- Protok vazduha od motora do radnog kola: položaj A (FMG).

### PRIBOR

- Gravitacioni zatvarač (SG).
- Bočna zaštitna rešetka radnog kola (PG-P). (Neophodno za upotrebu na slobodnom vazduhu)
- Regulatori brzine (SR).
- Odstojnik (SP)
- Servisni prekidač (SV).

### NA ZAHTEV

- Verzije bez bočne rešetke motora.
- Verzije sa sečivima od livenog aluminijuma.
- Verzije sa protokom vazduha od radnog kola do motora: položaj B (FGM).

### APPLICATIONS

PLATE-S line is ideal when are required large capacities with low pressures, in applications for wall or panel fixing: for instance: ventilation of industrial and commercial buildings, car parks, stock farms, or in the cooling of electric and refrigerating equipments, etc.

### RANGE

This line consists of 8 sizes with impeller diameter from 300 up to 700 mm.

### ADVANTAGES

The main characteristics of PLATE-S line are: the extreme compactness, due to the reduced protrusion of the electric motor; the perfect adjustability of speed, with reduced noise (electric hums) and consumption of current. This is due to the compact motor (without cooling fan) designed to be used exclusively in axial fans.

### CONSTRUCTION

- Supporting frame with wide shaped inlet in corrosion proof material or protected against the atmospheric agents.
- Motors support and safety grid, in steel rod, manufactured in accordance with UNI EN ISO 12499.
- High efficiency airfoil blades in plastic material and hub in die-cast aluminum alloy. Variable pitch angle.
- Balancing according to UNI ISO 21940-11.
- Asynchronous electric motor three or single phase with thermal protection, speed adjustable, protection IP 55, class F insulated, service S1.
- Arrangement 5 (impeller directly coupled to motor shaft).

### TECHNICAL SPECIFICATIONS

PLATE-S STANDARD

- Conveyed air: clean, not abrasive.
- Temperature of conveyed air: -20°C / +50°C
- Voltage: three-phase version (T) 400V-3Ph. single-phase version (M) 230V-1Ph.
- Frequency: 50Hz.
- Air flow from motor to impeller: position A (FMG).

### ACCESSORIES

- Gravity shutter (SG).
- Impeller side protection grid (PG-P). Necessary for use in free air.
- Speed regulators (SR).
- Spacer (SP).
- Service switch (SW).

### ON REQUEST

- Versions without motor side grid.
- Versions with die-cast aluminum blades.
- Versions with air flow from impeller to motor: position B (FGM).

# PLATE-S

## PERFORMANSE - PERFORMANCES

1 mm H<sub>2</sub>O = 9,8 Pa

Performanse prikazane u dijagramima za izbor odnose se na vazduh na temperaturi od 15 °C i na 0m nadmorske visine nadmorske visine, a dobijeni su u instalaciji tipa „B” bez mreže i pribora.

Performances shown in the selection diagrams refer to air at 15°C temperature and 0 mt a.s.l. altitude, and they were obtained in installation type “B” with no grid nor accessories.

### 4 POLA / POLES (1400 RPM)

#### MONOFAZNO / SINGLE-PHASE (1Ph-230V 50Hz)

Model Model	Brzina protoka Flow rate (m <sup>3</sup> /h)	Pm (kW)	In max (A)	Lp (dB(A))
314 M	2.300	0,09	0,8	52
354 M	3.500	0,09	0,8	57
404 M	6.000	0,18	1,7	62
454 M	7.000	0,25	2,2	66
504 M	8.500	0,25	2,3	69
564 M	11.500	0,55	3,8	72

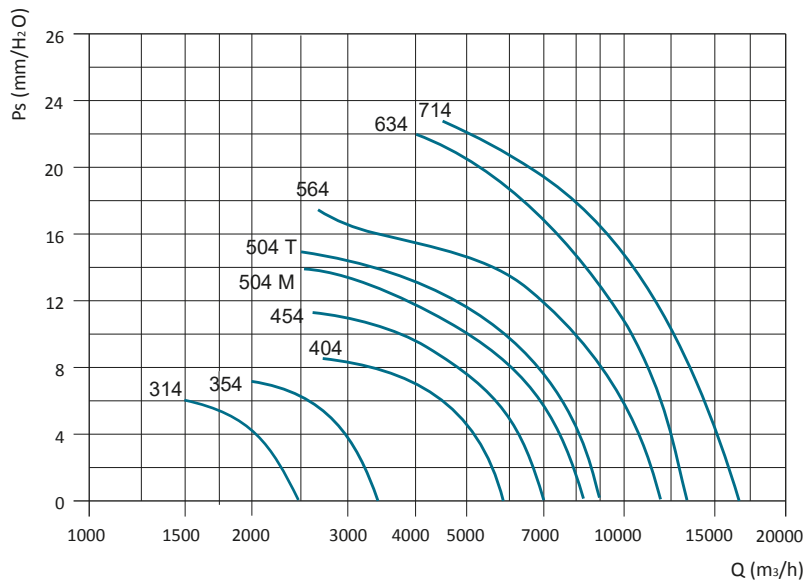

### 4 POLA / POLES (1400 RPM)

#### TROFAZNO / THREE-PHASE (3Ph-400V 50Hz)

Model Model	Brzina protoka Flow rate (m <sup>3</sup> /h)	Pm (kW)	In max (A)	Lp (dB(A))
314 T	2.300	0,09	0,5	52
354 T	3.500	0,09	0,5	57
404 T	6.000	0,18	0,75	62
454 T	7.000	0,25	1,1	66
504 T	9.000	0,35	1,5	69
564 T	11.500	0,55	1,6	72
634 T	13.500	0,74	2,2	76
714 T	17.000	1,1	2,6	77

Tolerancije: performanse i nivoi zvučne snage unutar tolerancija dozvoljenih standardom DIN 24166 za klasu 2

Tolerances: performances and sound power levels within the tolerances allowed by the DIN 24166 standard for Class 2.

### 6 POLA / POLES (900 RPM)

#### TROFAZNO / THREE-PHASE (3Ph-400V 50Hz)

Model Model	Brzina protoka Flow rate (m <sup>3</sup> /h)	Pm (kW)	In max (A)	Lp (dB(A))
566 T	9.500	0,25	1,2	62
636 T	13.000	0,55	1,7	66
716 T	14.500	0,55	1,7	67

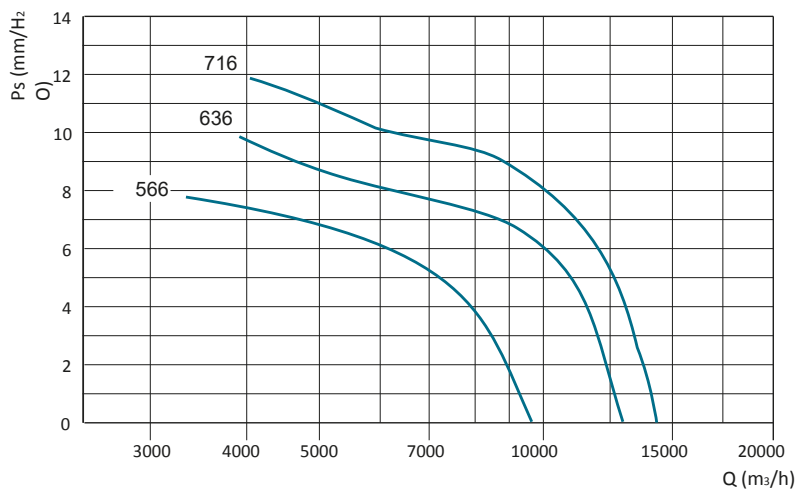

**PLATE-S****NIVO BUKE- NOISE LEVEL**

Model Model	63	125	250	500	1k	2k	4k	8k	Total
	Hz								
PLATE-S 314	34	43	45	46	47	44	38	29	32
PLATE-S 354	39	48	50	51	52	49	43	34	57
PLATE-S 404	44	53	55	55	56	53	48	38	62
PLATE-S 454	48	57	59	59	60	57	52	42	66
PLATE-S 504	51	60	62	63	64	61	55	46	69
PLATE-S 564	54	63	65	66	67	64	58	49	72
PLATE-S 566	44	53	55	56	57	54	48	39	62
PLATE-S 634	58	67	69	70	70	67	62	52	76
PLATE-S 636	48	56	59	59	60	57	52	42	66
PLATE-S 714	59	68	70	71	72	69	63	54	77
PLATE-S 716	49	58	60	61	62	59	53	44	67

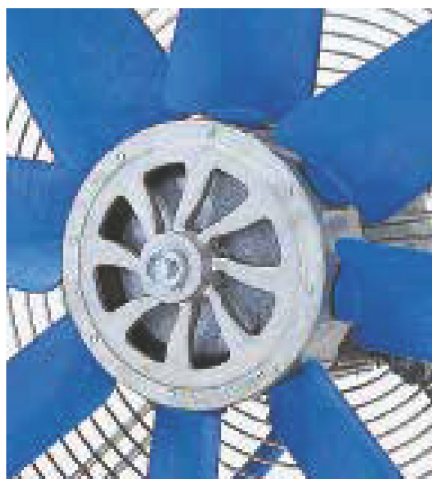

Pažnja: nivo zvučnog pritiska se meri u slobodnom polju na 3 m od ventilatora, u bilo kom smeru, sa slobodnim ulazom i izlazom.

*Attention: sound pressure level is measured in free field at 3 m from the fan, in any direction, with free inlet and outlet.*

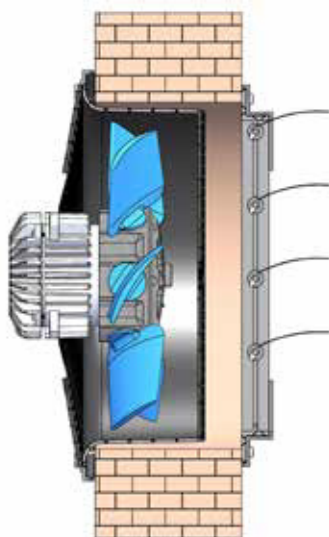
**PLATE-S****NAČIN INSTALACIJE - INSTALLATION METHOD**

UGRADNA INSTALACIJA  
RECESSED INSTALLATION

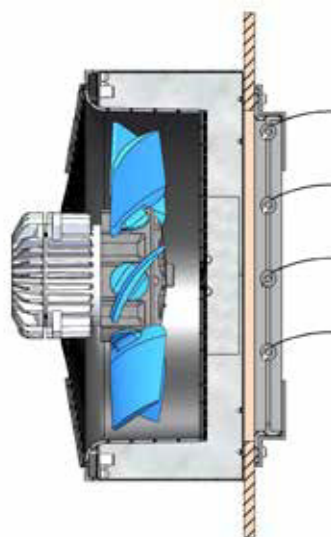

ZIDNA MONTAŽA SA MONTAŽNIM ODSTOJNIKOM  
WALL INSTALLATION WITH MOUNTING SPACER

## DIMENZIJE - DIMENSIONS

Model Model	ØA	BxB	CxC	ØD	E	F(*)	ØG	Kg(*)
31	310	390	350	10	110	170	365	7
35	360	440	400	10	110	170	410	7
40	410	500	450	10	110	170	465	9
45	460	560	510	10	110	175	510	10

Model Model	ØA	BxB	CxC	ØD	E	F(*)	ØG	Kg(*)
50	510	650	580	10	110	175	570	12
56	570	700	630	10	130	210	630	18
63	640	800	730	12	130	210	700	20
71	710	850	800	12	130	220	770	26

Dimenzionalne tolerancije u ± 5 mm - Dimensional tolerances ± 5 mm

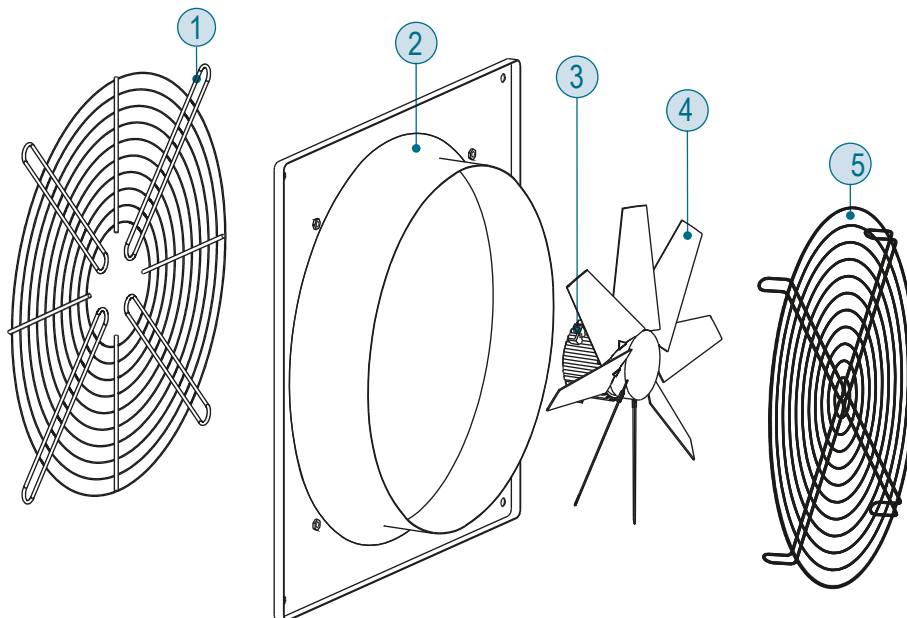
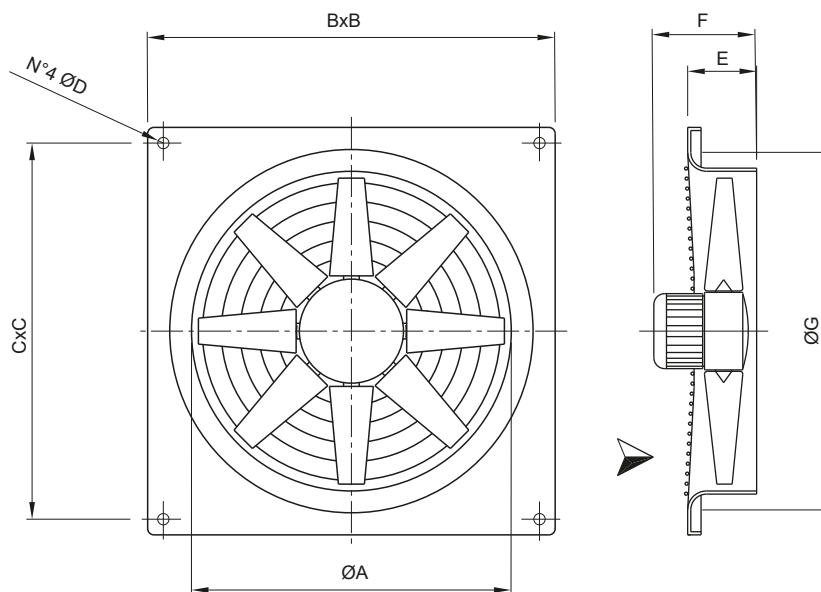

- 1 Mreža za nož motora (opciono)  
Motor support grid (optional)
- 2 Panel - Plate
- 3 Motor - Motor

- 4 Rotor - Impeller
- 5 "Dodatna" bočna mreža radnog kola  
(obavezna za slobodan vazduh)  
Grid impeller side "accessory"  
(mandatory for free air)

## PLATE-M

### PRIBOR - ACCESSORIES

#### SG e SG-HP: GRAVITACIONI ZATVARAČ

Rebra zatvarača se otvaraju kretanjem vazduha kada ventilator radi, a gase se gravitacijom kada je isključen, izbegavajući disperzije toplote, prodor kiše, vetra i ptica. Napravljeno od plastike (SG) ili čeličnog lima i plastike (SG-HP).

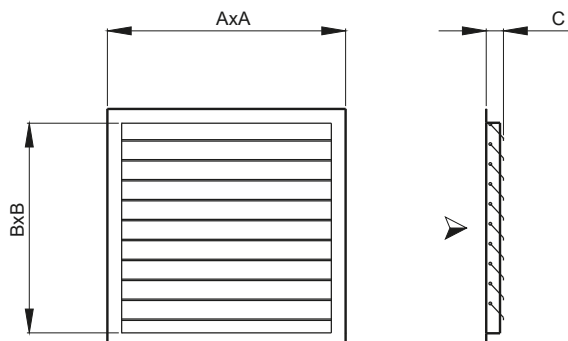

#### SG and SG-HP: GRAVITY SHUTTER

The fins of the shutter are opened by the air movement when the fan is operating and they shutdown by gravity when it is switched off, avoiding heat dispersions, the intrusion of rain, wind and birds.

Made in plastic material (SG) or steel sheet and plastic material (SG-HP).

Model Model	A	B	C	kg
SG 25- 31	370	300	35	0,6
SG 35	440	370	35	0,8
SG 40-45	510	440	35	1
SG 50	580	510	35	1,2
SG 56	650	580	35	1,6
SG 63	720	650	35	2,6
SG 71	785	715	35	3
SG-HP 80	920	850	25	6,8

#### DISTANCER: SP

Oni su obavezni da pričvrste zatvarač na ventilator kada zid ili ploča imaju debljinu manju od visine otvora zvona ventilatora.

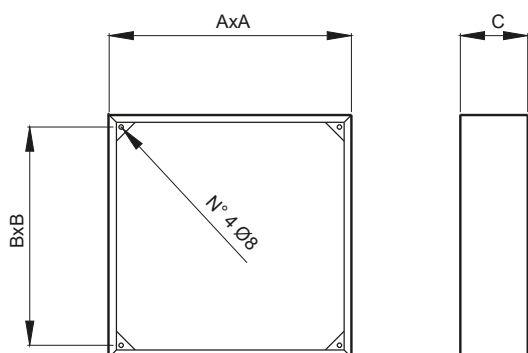

#### SPACER: SP

They are required to fix the shutter to the fan when the wall or the panel has a thickness lower than the height of the bell mouth of the fan.

Model Model	A	B	C	kg
SP 25	390	300	140	3
SP 31	390	350	140	3
SP 35	440	400	140	3,5
SP 40	510	450	140	4
SP 45	560	510	140	4,5
SP 50	630	580	140	5
SP 56	700	630	140	5,5
SP 63	790	730	140	6
SP 71	840	800	140	6,5
SP 80	940	900	200	9

#### BOČNA ZAŠTITA RADNOG KOLA: PG-P

Koristi se za izbegavanje upada ptica ili pacova sa strane rotora i za zaštitu od slučajnog kontakta sa rotirajućim impelerom. Proizveden je od čelične šipke u skladu sa aktuelnom sigurnosnom direktivom. (Neophodno za upotrebu na slobodnom vazduhu).

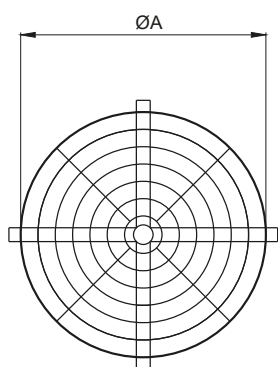

#### IMPELLER SIDE PROTECTION GUARD: PG-P

To be used to avoid the intrusion, from the impeller side, of birds or rats and to preserve from the casual contact with the rotating impeller. It is manufactured in steel rod according to the actual safety directive. (Necessary for use in free air).

Model Model	A	kg
PG-P 25	260	0,4
PG-P 31	320	0,6
PG-P 35	360	0,7
PG-P 40	410	0,9
PG-P 45	460	1
PG-P 50	510	1,3
PG-P 56	570	1,5
PG-P 63	640	1,8
PG-P 71	720	2,5
PG-P 80	820	3