

RING

AKSIJALNI PRSTENAST VENTILATOR RING AXIAL FAN



APLIKACIJE

Ventilatori serije RING su idealni kada su potrebni veliki protok vazduha i relativno skromni pritisci, u aplikacijama sa fiksiranjem na zid, nosećom konstrukcijom ili kanalom u terminalnoj poziciji. Na primer: ventilacija fabrika, parkinga, farmi, u hlađenju električne i rashladne opreme.

DOMET

Seriya se sastoji od 15 veličina sa prečnikom radnog kola od 300 do 1600 mm.

KARAKTERISTIKE

Seriya RING se odlikuje izuzetnom čvrstoćom zbog ojačane konstrukcije nosivog okvira, izgrađenog sa većim debljinama od onih kod normalnih kvadratnih panela. Pored toga, prisustvo ulaza sa širokim radijusom zakrivljenosti napravljenih direktno od ferule, garantuje maksimalnu tišinu i aerodinamičnu efikasnost koja se može postići aksijalnim kanalom samo uz dodatak usisne mlaznice. Ova konstrukcija u kombinaciji sa našim reverzibilnim radnim kolom sa simetričnim profilom omogućava da se optimizuju potrebe reverzibilnosti protoka. U stvari, aksijalni ventilatori generalno dozvoljavaju reverzibilnost jednostavnim invertovanjem dve fazne linije na izvoru napajanja, ili sklapanjem 50% lopatica sa protokom pod pritiskom i 50% ostalih sa usisnim protokom; u oba slučaja sa veoma niskom aeroličnom efikasnošću. Upotreba serije RING sa reverzibilnim radnim kolom sa simetričnim profilom, sa druge strane, omogućava postizanje istih performansi kako u usisu, tako i u isporuci uz visoku efikasnost.

KONSTRUKCIJA

- Prstenasti transporter, sa usnikom širokog radijusa, od lima
- čelik zaštićen epoksidno-poliesterskom bojom.
- Sigurnosna mreža na strani motora, izrađena u skladu sa UNI EN ISO 12499, inčelična žica i zaštićena od atmosferskih uticaja.
- Radno kolo visokih performansi sa zakošenim lopaticama aeroprofila varijabilni ključ iz mirovanja, od tehnopolimera ili od aluminijuma, glavčina od livenog aluminijuma. Balansiranje prema UNI ISO 219 standardima 21940-11.
- Elektromotor, IP 55 zaštita, CI F izolacija, S1 servis, konstrukcija u skladu sa specifičnim IEC/EEC standardima (UNEL-MEC).
- Izvedba 4 (direktna spojnica sa konzolnim radnim kolom).

TEHNIČKE SPECIFIKACIJE

- RING standard
- Vazduh koji se prenosi: čist ili malo prašnjav, neabrazivan.
- Temperatura transportovanog vazduha: -20°C / $+50^{\circ}\text{C}$.
- Verzija napajanja: trofazno (T) 400V-3Ph - 50Hz.
jednofazni (M) 230V-1ph - 50Hz.
- Protok vazduha od motora do radnog kola, položaj A (FMG).

VERZIJE

- RING dr: transporter sa dvostruko zaobljenom ivicom.
- RING sr: jednostavan transporter sa zaobljenim ivicama.

PRIBOR

- Bočna sigurnosna mreža radnog kola (PG-P / RIsr - FPG / RIdr). (Neophodno za upotrebu sa slobodnim ustima)
- Gravitacioni zatvarač (SG i GS)
- Eksterni terminalni blok (OTB).
- Servisni prekidač (SV).
- Kvadratni panel (SK).
- Noge za fiksiranje (FF-RI).

NA ZAHTEV

- Verzije bez mreže motora.
- Usluge koje nisu prikazane
- Verzija sa radnim kolom u potpunosti od livenog aluminijuma.
- Verzija sa "efikasno" reverzibilnim protokom vazduha (RING-rev).
- Verzija sa transporterom od nerđajućeg čelika ili aluminijuma.
- Verzija sa dvoivičnim transporterom, zaobljena i strana radnog kola ravna, (RING drp-g) ili ravna strana motora (Ring drp-m)
- ATEXverzija (RING-Atex).
- Verzija sa protokom vazduha od radnog kola do motora, pozicija B (FGM).
- Verzija sa motorom u obliku B5, pričvršćena na transporter pomoću mreže.

APPLICATIONS

RING line is ideal when large air capacities are required; in applications for wall, panel or duct fixing. For instance: ventilation of industrial buildings, car parks, stock farms, cooling of electric and refrigerating equipments etc. **RANGE**

This line consists of 15 sizes with impeller diameter from 300 up to 1600 mm. **ADVANTAGES**

RING line is characterized by the extreme sturdiness due to the strengthen construction of the casing manufactured with thickness higher than the standard PLATE fans. The wide round shaped cones directly drawn on the casing guarantee maximum silent and efficiencies normally obtained only in axial fan with bell mouth. This construction together with our fully reversible simmetrical profile impellers allows getting the 100% reversibility of the airflow. Normally the axial fans allow the reversibility of the airflow by switching two lines of phase of the electric supply and assembling 50% of the blades for intake and the other 50% for exhaust; in both cases with very low efficiencies. The use of the RING line with the fully reversible simmetrical profile impeller, consents to obtain the same performances in both the airflow directions with high efficiencies.

CONSTRUCTION

- RING casing, with wide round shaped nozzle, in epoxy painted steel sheet.
- Motor side protection grid, manufactured according to UNI EN ISO 12499, and protected against the atmospheric agents.
- Impeller with high efficiency airfoil blades, in plastic material or in die-cast aluminum alloy; hub is in die-cast aluminum alloy.
- Balancing according to UNI ISO 21940-11. Variable pitch angle in still position.
- Electric motor, protection IP 55, class F insulated, service S1, construction according to IEC/EEC (UNEL-MEC).
- Arrangement 4 (impeller directly coupled to motor shaft):

SPECIFICHE TECNICHE

- Conveyed air: clean, not abrasive.
- Temperature of conveyed air: -20°C / $+50^{\circ}\text{C}$.
- Voltage: three-phase version (T) 400V-3Ph - 50Hz
single-phase version (M) 230V-1Ph-50Hz
- Air flow from motor to impeller, position A (FMG).

VERSIONS

- RING dr: casing with two round shaped nozzles.
- RING sr: casing with round shaped nozzle only on inlet.

ACCESSORIES

- Protection grid, impeller side (FPG/RIsr - FPG/RIdr).
- Gravity shutter (SG and SG-HP). (Necessary for use in free air)
- Outer terminal box (OTB).
- Service switch (SW).
- Square panel (SQ).
- Fixing feet (FF-RI).

ON REQUEST

- Version without motor side grid.
- Performances differing from standard
- Version with die-cast aluminum blades.
- Version with true reversible air flow direction (RING-rev)
- Version with casing in stainless steel, aluminum or hot dip galvanised steel.
- Version with casing with one round shaped inlet and one flat, impeller side (RING drp-g) or motor side (Ring drp-m).
- Explosion proof version (RING-Atex).
- Version with air flow from impeller to motor, position B (FGM).
- Version with B5 motor mounting type, fixed to the casing through a grid.

Performanse prikazane na dijagramima odnose se na vazduh na temperaturi od 15°C i nadmorskoj visini od 0 metara, a dobijene su u instalacijama tipa "D" u odsustvu mreže i pribora.

Performance shown in the selection diagrams refer to the airflow from impeller to air at 15°C temperature and 0 mt a.s.l. altitude, and they were obtained in installation type "D" with no grid nor accessories.

2 POLA / POLES (3000 RPM) MONOFAZNO / SINGLE-PHASE (1Ph-230V 50Hz)

Model Model	Brzina protoka Flow rate (m ³ /h)	Pm (kW)	In max (A)	Mot. (H)	Lp (dB(A))	Kg
312/A M	3.500	0,25	1,7	63	70	14
352/A M*	5.100	0,55	4	71	74	19
402/A M*	8.200	1,1	8	80	79	26

2 POLA / POLES (3000 RPM) TROFAZNO / THREE-PHASE (3Ph-400V 50Hz)

Model Model	Brzina protoka Flow rate (m ³ /h)	Pm (kW)	In max (A)	Mot. (H)	Lp (dB(A))	Kg
312/A T	3.500	0,25	0,7	63	70	14
352/A T	5.100	0,55	1,6	71	74	19
402/A T	8.200	1,1	2,6	80	79	26

4 POLA / POLES (1500 RPM) MONOFAZNO / SINGLE-PHASE (1Ph-230V 50Hz)

Model Model	Brzina protoka Flow rate (m ³ /h)	Pm (kW)	In max (A)	Mot. (H)	Lp (dB(A))	Kg
314/A M	2.300	0,09	1	56	52	9
354/A M	3.200	0,09	1	56	56	13
404/A M*	4.000	0,12	1,1	63	61	14
404/B M*	5.200	0,18	1,4	63	62	14
454/A M*	6.500	0,25	1,8	71	65	19
454/B M*	7.600	0,37	3,3	71	66	20

4 POLA / POLES (1500 RPM) TROFAZNO / THREE-PHASE (3Ph-400V 50Hz)

Model Model	Brzina protoka Flow rate (m ³ /h)	Pm (kW)	In max (A)	Mot. (H)	Lp (dB(A))	Kg
314/A T	2.300	0,09	0,4	56	52	9
354/A T	3.200	0,09	0,4	56	56	13
404/A T*	4.000	0,12	0,5	63	61	14
404/B T	5.200	0,18	0,6	63	62	15
454/A T	6.500	0,25	0,8	71	65	19
454/B T	7.600	0,37	1,2	71	66	20
504/A T*	8.000	0,37	1,2	71	68	21
504/B T	9.000	0,55	1,6	80	69	28
564/A T*	10.000	0,55	1,6	80	71	30
564/B T	12.500	0,75	2	80	72	32
634/A T	13.000	0,75	2	80	75	38
634/B T	16.000	1,1	2,8	90	76	46
634/C T	17.000	2,2	5	100	76	57
714/A T	17.000	1,5	3,5	90	77	48
714/B T	20.500	2,2	5	100	77	64
714/C T	18.500	2,2	5	100	77	64
714/D T	23.500	3	6,5	100	79	67
804/A T	24.000	3	6,5	100	78	74
804/B T	29.000	4	8,2	112	79	82
804/C T	35.000	5,5	11	132	80	91
804/D T	40.000	7,5	15	132	80	100
904/A T	38.000	5,5	11	132	85	110
904/B T	43.000	7,5	15	132	86	118
904/C T	47.000	7,5	15	132	86	119
904/D T	52.500	9,2	18	132	86	125
1004/A T	41.000	5,5	11	132	88	135
1004/B T	50.000	7,5	15	132	89	145
1004/C T	59.000	11	21	160	89	205

6 POLA / POLES (1000 RPM) TROFAZNO / THREE-PHASE (3Ph-400V 50Hz)

Model Model	Brzina protoka Flow rate (m ³ /h)	Pm (kW)	In max (A)	Mot. (H)	Lp (dB(A))	Kg
506/A T*	6.000	0,18	0,7	71	58	22
566/A T	8.500	0,25	1	71	62	24
636/A T	12.000	0,37	1,3	80	66	35
636/B T	14.000	0,75	2,2	90	65	45
716/A T	16.000	0,75	2,2	90	67	48
716/B T	17.000	1,1	3	90	66	50
806/A T	16.000	0,75	2,2	90	68	52
806/B T	19.000	1,1	3	90	68	54
806/C T	22.500	1,5	4	100	69	72
906/A T	25.000	1,5	4	100	74	74
906/B T	29.000	2,2	5	112	75	92
906/C T	32.000	2,2	5	112	75	92
1006/A T	27.000	1,5	4	100	79	95
1006/B T	33.000	2,2	5	112	79	110
1006/C T	41.000	3	7	132	80	134
1126/B T	45.000	4	9	132	83	146
1126/C T	54.000	5,5	12	132	83	154
1256/B T	55.000	7,5	15	160	87	230
1256/C T	70.000	11	22	160	88	255

8 POLA / POLES (750 RPM) TROFAZNO / THREE-PHASE (3Ph-400V 50Hz)

Model Model	Brzina protoka Flow rate (m ³ /h)	Pm (kW)	In max (A)	Mot. (H)	Lp (dB(A))	Kg
568/A T	6.000	0,12	0,7	71	56	22
638/A T*	8.000	0,18	0,8	80	60	37
718/A T*	11.000	0,37	1,5	90	61	49
808/A T*	10.000	0,37	1,5	90	61	55
808/B T*	13.000	0,37	1,5	90	62	55
908/A T	17.000	0,75	2,3	100	69	70
908/B T	20.500	0,75	2,3	100	74	71
1008/A T	20.500	0,75	2,3	100	74	90
1008/B T	25.000	1,1	3,4	100	74	93
1128/C T	40.500	2,2	5,5	132	77	134
1258/A T	34.500	2,2	5,5	132	81	165
1258/B T	43.000	3	7,3	132	81	176
1258/C T	52.000	4	9,3	160	82	215

Tolerancije: aerodinamičke performanse i buka su unutar tolerancija navedenih u DIN 24166, klasa 2.

*Samo za dodatnu instalaciju U.E

TOLERANCES: performances and sound power levels within the tolerances allowed by the DIN 24166 standard for Class 2.

* ONLY FOR-NON EUROPEAN MARKET

RING

PERFORMANSE - PERFORMANCES

1 mm H₂O = 9,8 Pa

Performanse prikazane na dijagramima odnose se na vazduh na temperaturi od 15 °C i nadmorskoj visini od 0 m., a dobijeni su u instalacijama tipa "D" u nedostatku mreže i pribora.

Performance shown in the selection diagrams refer to the airflow from impeller to air at 15°C temperature and 0 mt a.s.l. altitude, and they were obtained in installation type "D" with no grid nor accessories.

RING 310

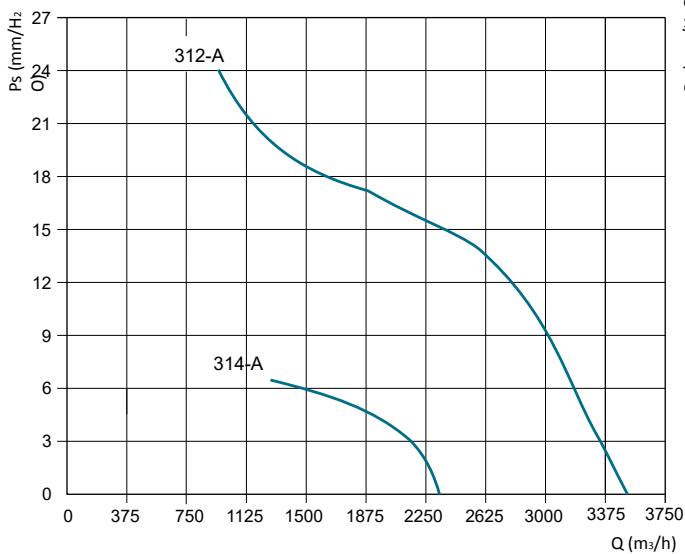

RING 350

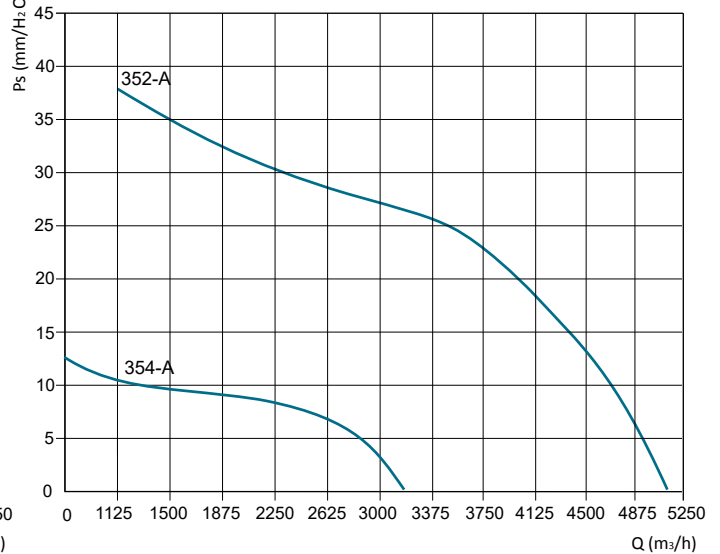

RING 400

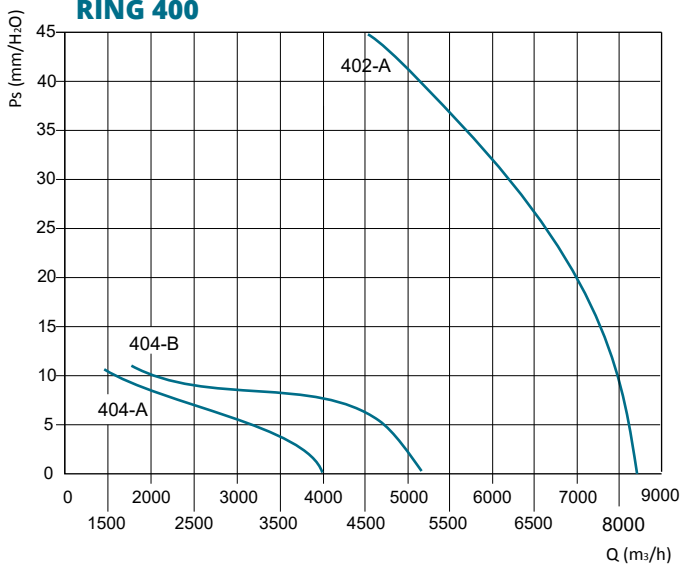

RING 450

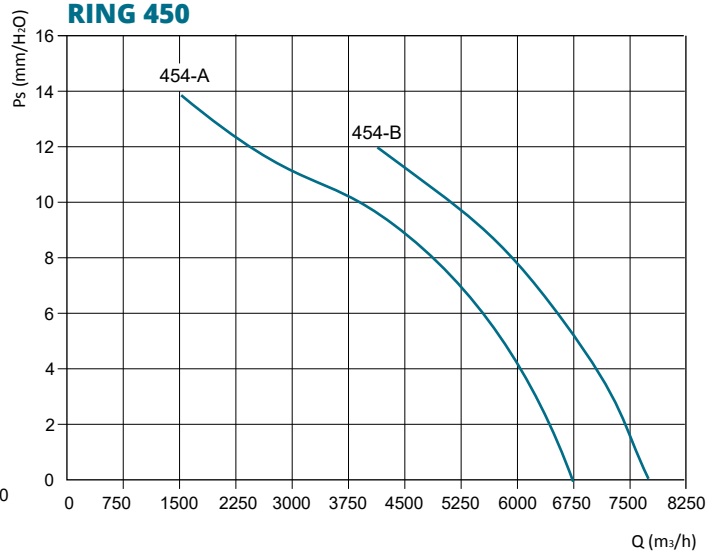

RING 500

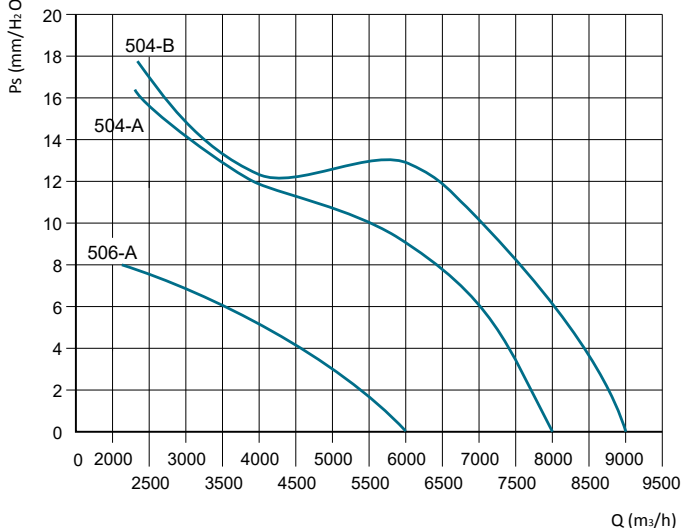

RING 560

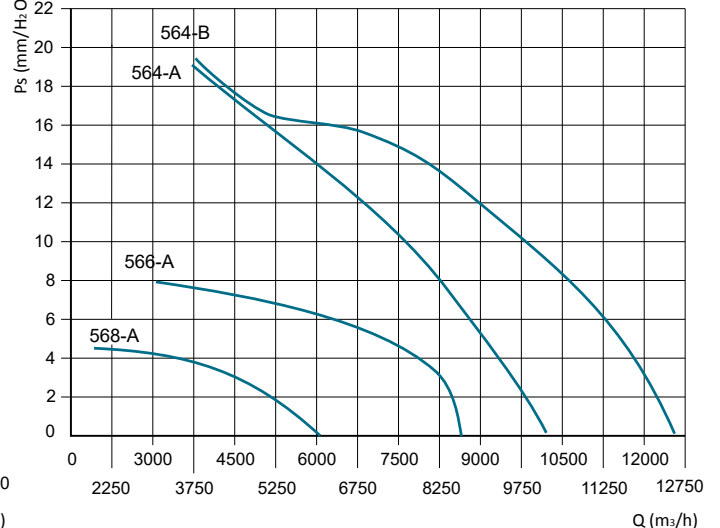

RING

PERFORMANSE - PERFORMANCES

1 mm H₂O = 9,8 Pa

Performanse prikazane na dijagramima odnose se na vazduh na temperaturi od 15 °C i nadmorskoj visini od 0 m., a dobijeni su u instalacijama tipa "D" u nedostatku mreže i pribora.

Performance shown in the selection diagrams refer to the airflow from impeller to air at 15°C temperature and 0 mt a.s.l. altitude, and they were obtained in installation type "D" with no grid nor accessories.

RING 630

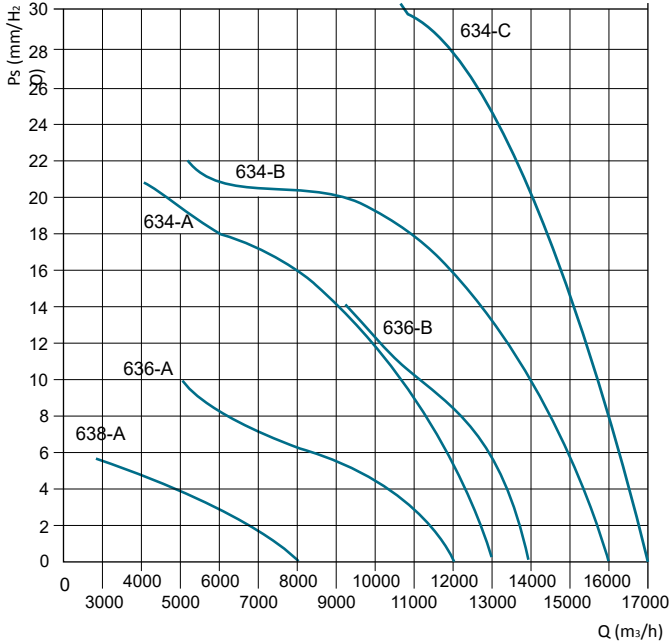

RING 710

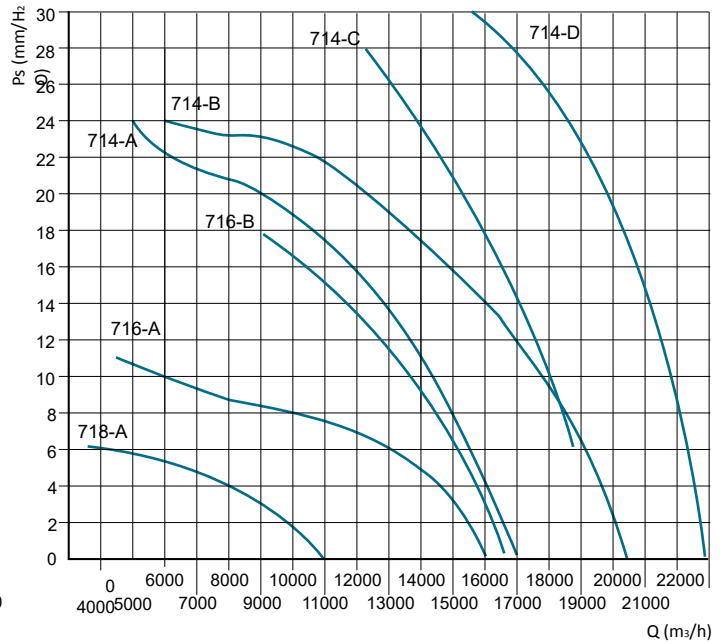

RING 800 - 4 poles

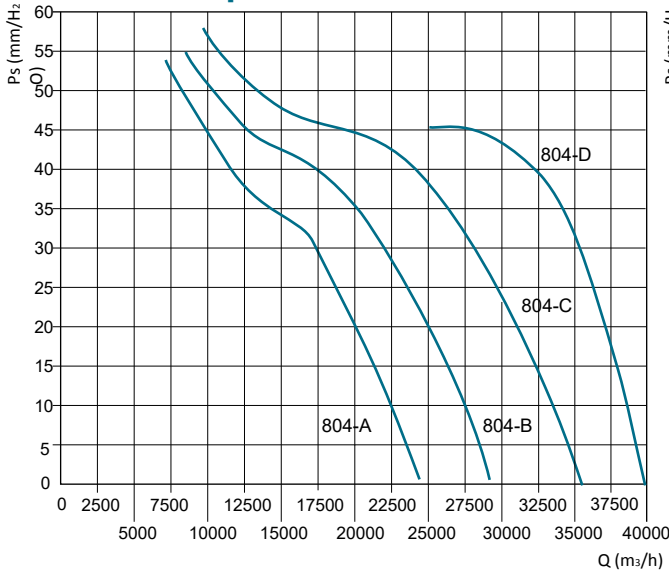

RING 800 - 6 poles - 8 poles

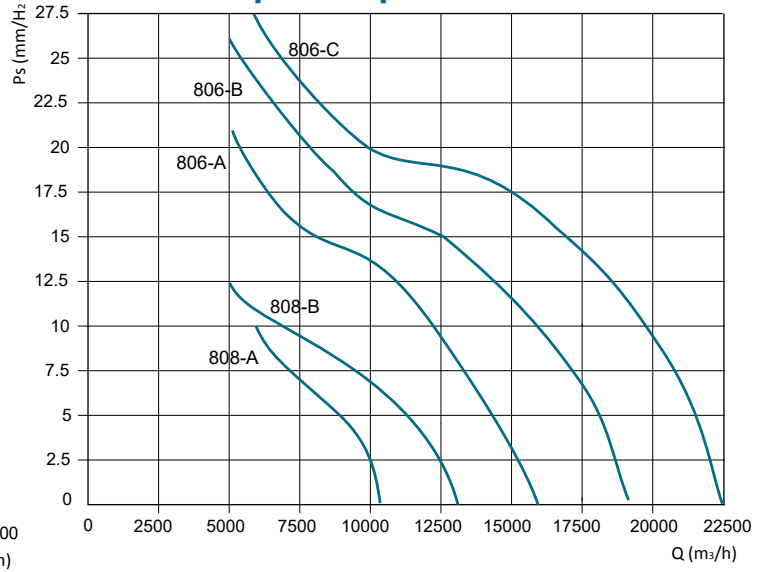

RING 900 - 4 poles

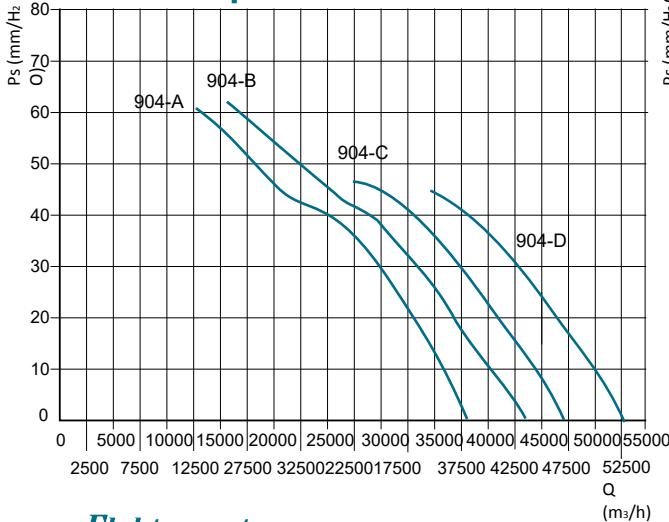

RING 900 - 6 poles - 8 poles

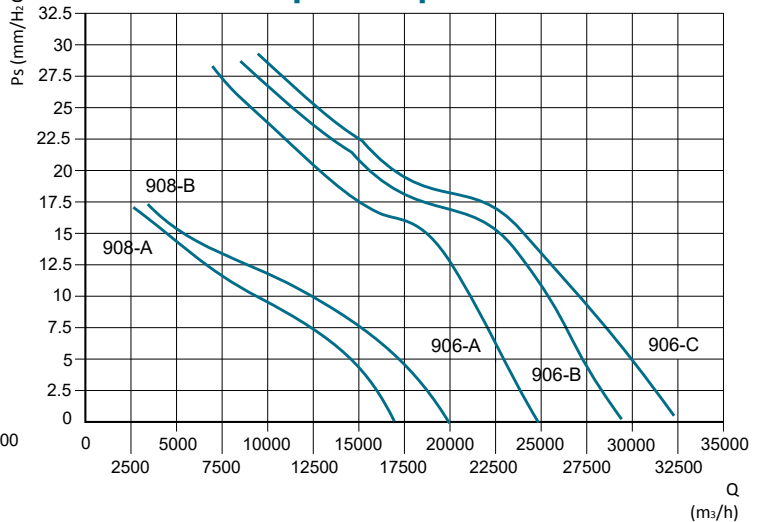

RING

PERFORMASE - PERFORMANCES

1 mm H₂O = 9,8 Pa

Performanse prikazane na dijagramima odnose se na vazduh na temperaturi od 15 °C i nadmorskoj visini od 0 m., a dobijeni su u instalacijama tipa "D" u nedostatku mreže i pribora.

Performance shown in the selection diagrams refer to the airflow from impeller to air at 15°C temperature and 0 mt a.s.l. altitude, and they were obtained in installation type "D" with no grid nor accessories.

RING 1000 - 4 poles

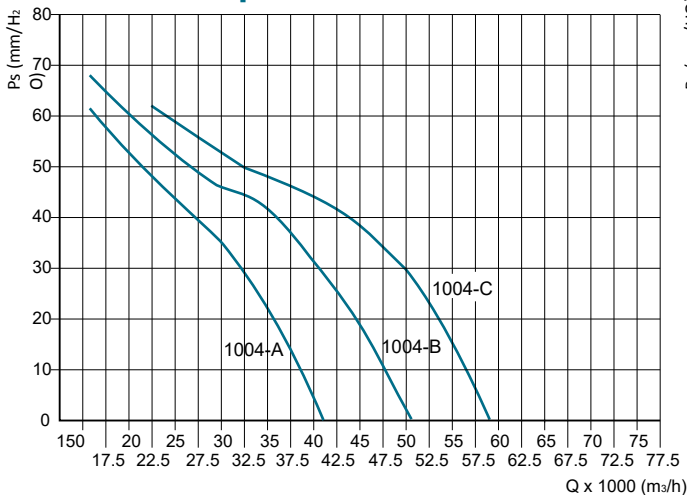

RING 1000 - 6 poles - 8 poles

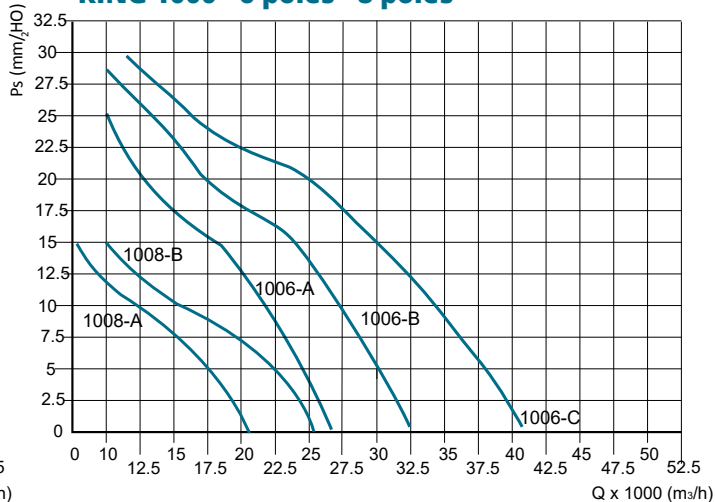

RING 1120 - 6 poles - 8 poles

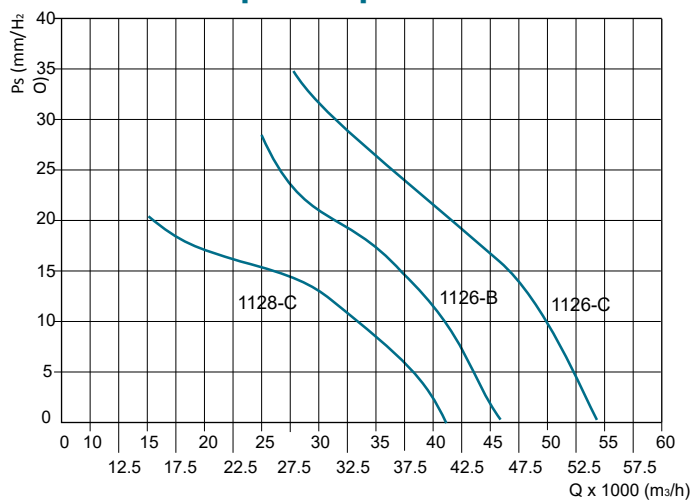

RING 1250 - 6 poles

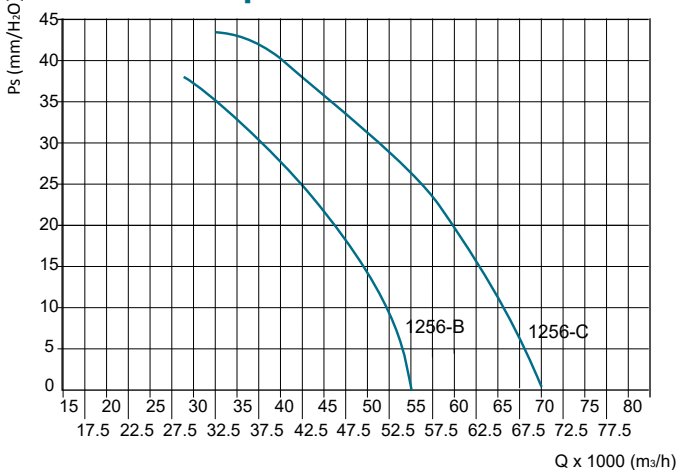

RING 1250 - 8 poles

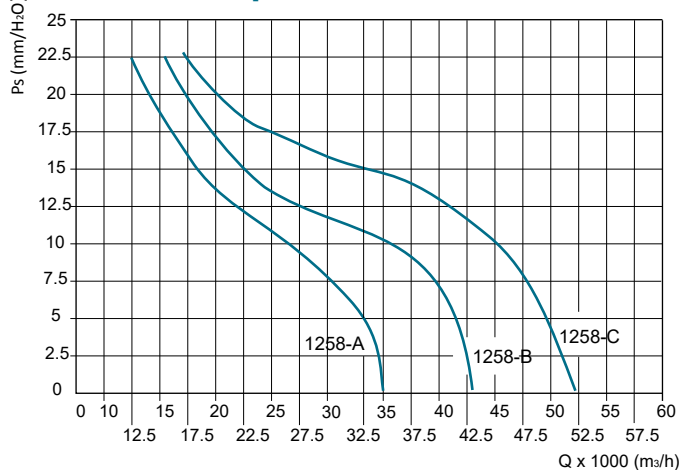

RING**NIVO BUKE - NOISE LEVEL**

2 POLA / 2 POLES

Model Model	63	125	250	500	1k	2k	4k	8k	Total
	Hz								
312/A - 0,25 kW	52	61	63	64	65	62	56	47	70
352/A - 0,55 kW	56	65	67	67	68	66	60	51	74
402/A - 1,1 kW	61	70	72	72	73	70	65	56	79

4 POLA / 4 POLES

Model Model	63	125	250	500	1k	2k	4k	8k	Total
	Hz								
314/A - 0,12 kW	34	43	45	46	47	44	38	29	52
354/A - 0,12 kW	38	47	49	50	51	48	42	33	56
404/A - 0,12 kW	43	52	54	55	56	53	47	38	61
404/B - 0,18 kW	44	53	55	55	56	53	48	38	62
454/A - 0,25 kW	47	56	58	59	60	57	51	42	65
454/B - 0,37 kW	48	57	59	59	60	57	52	42	66
504/A - 0,37 kW	50	59	61	61	63	59	54	44	68
504/B - 0,55 kW	51	60	62	62	63	60	55	45	69
564/A - 0,55 kW	54	62	64	65	66	63	57	48	71
564/B - 0,75 kW	54	63	65	66	67	64	58	49	72
634/A - 0,75 kW	57	66	68	69	70	67	61	52	75
634/B - 1,1 kW	57	65	68	68	69	66	61	51	76
634/C - 2,2 kW	58	66	69	69	70	67	62	52	76
714/A - 1,5 kW	59	68	70	70	71	68	63	53	77
714/B - 2,2 kW	60	68	70	71	72	69	63	54	77
714/C - 2,2 kW	59	68	70	70	71	68	63	53	77
714/D - 3 kW	59	68	70	71	72	69	63	54	77
804/A - 3 kW	60	70	71	72	73	70	64	55	78
804/B - 4 kW	60	70	71	72	73	70	64	55	79
804/C - 5,5 kW	61	70	72	73	74	71	65	56	80
804/D - 7,5 kW	61	70	72	73	74	71	65	56	80
904A/ - 5,5 kW	67	76	78	79	80	77	71	62	85
904/B - 7,5 kW	68	77	79	79	80	77	72	62	86
904/C - 7,5 kW	68	77	79	79	80	77	72	62	86
904/D - 9,2 kW	68	77	79	79	80	77	72	62	86
1004/A - 5,5 kW	70	79	82	82	83	80	74	65	88
1004/B - 7,5 kW	71	80	82	83	84	81	75	66	89
1004/C - 11 kW	71	80	82	83	84	81	75	66	89



Ova linija se sastoji od 15
veličina sa prečnikom
impelera od 300
do 1600 mm.

*This line consists of 15 sizes
with impeller diameter from
300 up to 1600 mm.*

RING**NIVO BUKE- NOISE LEVEL**

6 POLA / 6 POLES

Model Model	63	125	250	500	1k	2k	4k	8k	Total
	Hz								
506/A - 0,18 kW	40	49	51	52	53	50	44	35	58
566/A - 0,25 kW	44	53	55	55	46	54	48	39	62
636/A - 0,37 kW	48	57	59	59	69	57	52	42	66
636/B - 0,75 kW	47	56	58	59	60	57	51	42	65
716/A - 0,75 kW	49	58	60	60	61	58	53	43	67
716/B - 1,1 kW	48	57	59	60	61	58	52	43	66
806/A - 0,75 kW	50	59	61	61	62	59	54	44	68
806/B - 1,1 kW	50	59	61	61	62	59	54	44	68
806/C - 1,5 kW	50	59	61	62	63	60	54	45	69
906/A - 1,5 kW	56	65	67	68	69	66	60	51	74
906/B - 2,2 kW	57	66	68	68	69	66	61	51	74
906/C - 2,2 kW	57	66	67	68	69	66	61	51	75
1006/A - 1,5 kW	61	70	72	72	73	70	65	55	79
1006/B - 2,2 kW	61	70	72	72	73	71	65	56	79
1006/C - 3 kW	61	70	73	73	74	71	65	56	80
1126/B - 4 kW	65	74	76	76	77	74	69	60	83
1126/C - 5,5 kW	65	74	76	77	78	75	69	60	83
1256/B - 7,5 kW	69	78	80	80	81	78	73	63	87
1256/C - 11 kW	70	78	80	81	82	79	73	64	88

8 POLA / 8 POLES

Model Model	63	125	250	500	1k	2k	4k	8k	Total
	Hz								
568/A - 0,12 kW	38	47	49	49	50	48	42	33	56
638/A - 0,18 kW	42	51	53	53	54	51	46	36	60
718/A - 0,37 kW	43	52	54	54	55	52	47	37	61
808/A - 0,37 kW	44	52	54	54	55	53	47	38	61
808/B - 0,37 kW	44	53	55	55	56	53	48	38	62
908/A - 0,75 kW	51	60	62	63	64	61	55	46	69
908/B - 0,75 kW	51	60	62	63	64	61	55	46	69
1008/A - 0,75 kW	55	64	66	67	68	65	60	50	74
1008/B - 1,1 kW	56	64	67	67	68	65	60	50	74
1128/C - 2,2 kW	59	68	70	71	72	69	63	54	77
1258/A - 2,2 kW	63	72	74	75	76	73	67	58	81
1258/B - 3 kW	63	72	74	75	76	73	67	58	81
1258/C - 4 kW	63	72	75	75	76	73	68	58	82

Upozorenje: nivo zvučnog pritiska se odnosi na omnidirekciono merenje u slobodnom polju na 3 m od ventilatora sa kanalnim usisom i isporukom.

ATTENTION: sound pressure level is measured in free field at 3 m from the fan, in any direction, with ducted inlet and outlet.



RING

DIMENZIJE - DIMENSIONS

Model Model	ØA	B(sr)	B(dr)	B(drp)	ØC	ØD	E(*)	ØF	ØG	n°H	ØI	n°L	ØM
25	250	135	150	150	310	320	315	285	310	4	8	8	10
31	310	135	150	150	365	390	345	355	390	4	8	8	10
35	360	135	150	150	430	455	360	395	430	4	8	8	10
40	410	135	150	150	480	510	390	450	480	4	10	8	12
45	460	150	150	150	535	560	390	500	530	4	10	8	12
50	510	150	150	150	590	620	400	560	595	8	10	12	12
56	570	180	180	180	645	680	450	620	655	8	10	12	12
60	610	180	180	180	680	720	480	640	670	8	10	12	12
63	640	180	180	180	720	750	480	690	725	8	10	12	12
71	710	180	180	180	780	816	510	770	805	8	12	16	12
80	810	200	200	200	880	915	610	860	900	8	12	16	12
90	910	250	250	250	980	1015	750	970	1010	16	12	16	16
100	1010	250	250	250	1080	1115	800	1070	1110	16	12	16	16
112	1130	250	250	250	1226	1250	940	1190	1230	16	12	20	16
125	1260	260	260	260	1350	1380	990	1320	1360	16	12	20	16
140	1400	400	400	400	1580	1620	1050	1470	1520	20	16	20	16
160	1610	450	450	450	1810	1860	1100	1680	1735	24	16	24	20

Dimenzionalne tolerancije u ± 5 mm - Dimensional tolerances ± 5 mm

RING sr

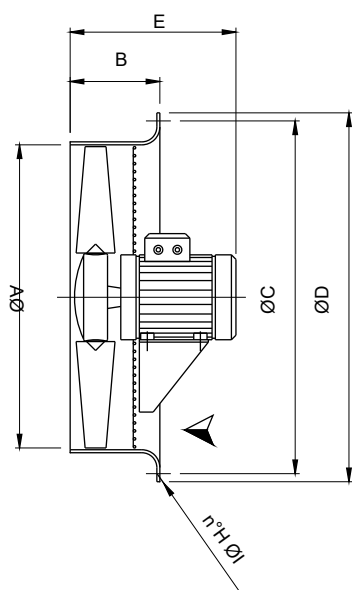

RING dr

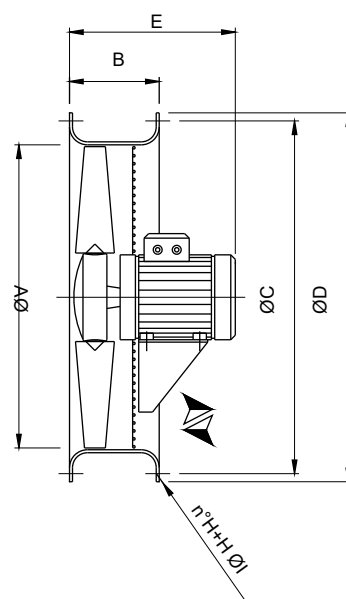

RING drp-m

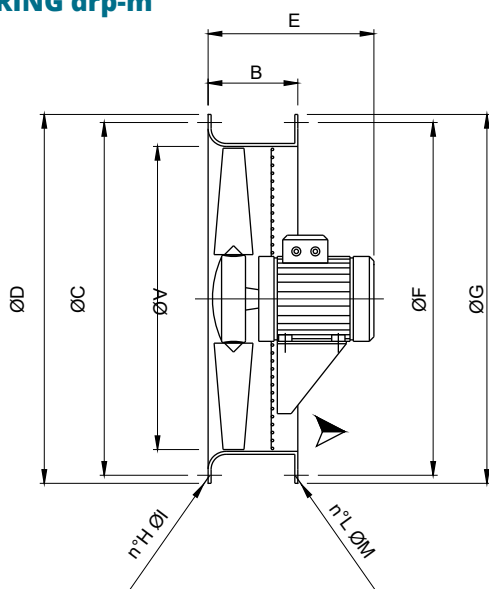

RING drp-g

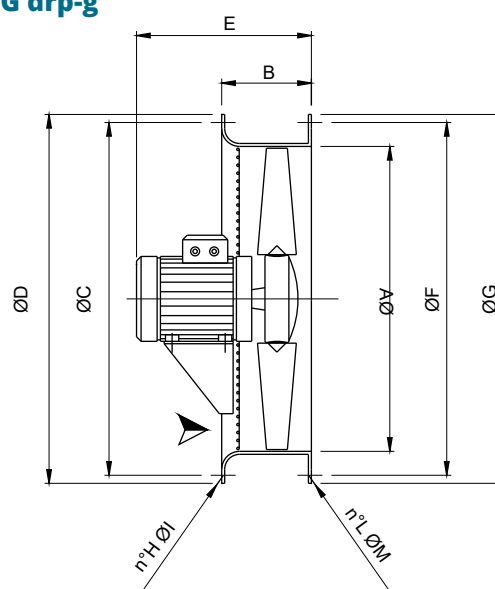

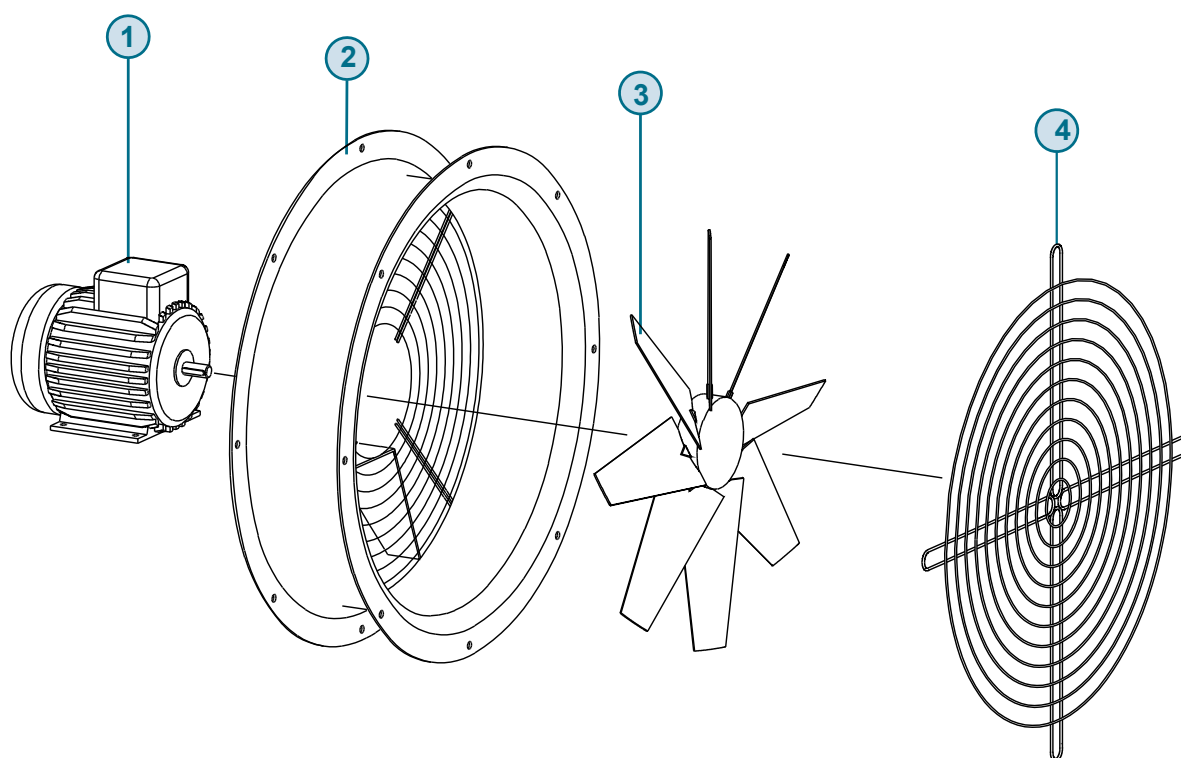
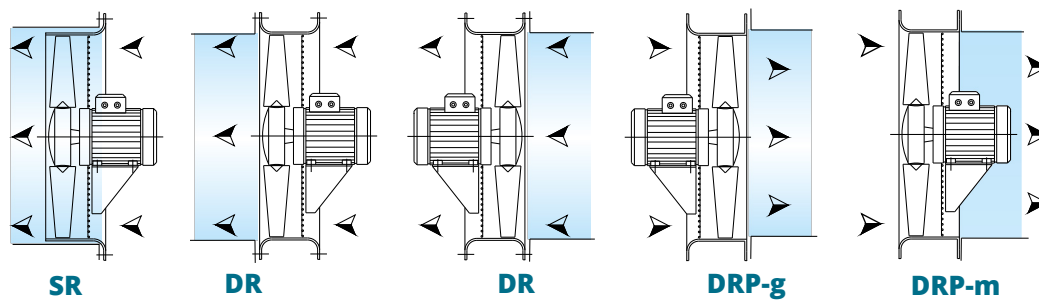

- **1** Motor - *Motor*
- **2** Transporter, sa bočnom mrežom motora (opciono) - *Casing with motor side grid*
- **3** Radno kolo - *Impeller*
- **4** Bočna mreža radnog kola "dodatak" (obavezno za slobodan vazduh) - *Grid impeller side "accessory" (mandatory for free air)*



RING

PRIBOR - ACCESSORIES

BOČNA MREŽA RADNOG KOLA: FPG-RI

Koristi se za izbegavanje upada, sa strane radnog kola, ptica, glodara i sprečavanje slučajnog kontakta sa rotirajućim impelerom. Izrađen od elektroavarene čelične žice, u skladu sa propisima o zaštiti od nezgoda. Mora se navesti da li je za RING-sr (PG-P / Rlsr) ili RING-dr (FPG-Rldr). (Neophodno za upotrebu sa slobodnim ustima)

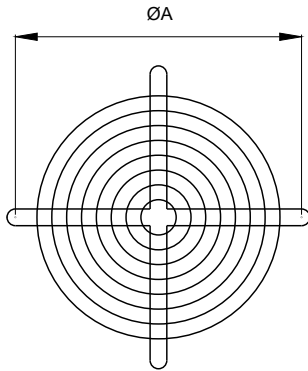

IMPELLER SIDE PROTECTION GUARD: FPG-RI

To be used to avoid the intrusion, from the impeller side, of birds or rats and to preserve from the casual contact with the rotating impeller. It is manufactured in steel rod according to the actual safety directive. Shall be specified if required for RING-sr (PG-P/Rlsr) or RING-dr (FPG-RI dr). (Necessary for use in free air).

Model Model	ØA	kg
FPG-RI 31	355	0,6
FPG-RI 35	395	0,7
FPG-RI 40	450	0,9
FPG-RI 45	500	1
FPG-RI 50	560	1,3
FPG-RI 56	620	1,5
FPG-RI 63	690	1,8
FPG-RI 71	770	2,5

Model Model	ØA	kg
FPG-RI 80	860	3
FPG-RI 90	970	4
FPG-RI 100	1070	5
FPG-RI 112	1190	8
FPG-RI 125	1320	10
FPG-RI 140	1580	14
FPG-RI 160	1810	20

GRAVITACIJSKI POKLOPAC: SG E SG-HP

SG - GS - Zaklopci zatvarača se otvaraju kretanjem vazduha sa uključenim ventilatorom i zatvaraju gravitacijom kada je isključen, izbegavajući gubitak toplote, ulazak kiše, vetra i ptica. Napravljeno od plastike (SG) ili čeličnog lima i plastike (SG-HP).

GRAVITY SHUTTER: SG AND SG-HP

The fins of the shutter are opened by the air movement when the fan is operating and they shutdown by gravity when it is switched off, avoiding heat dispersions, the intrusion of rain, wind and birds. Made in plastic material (SG) or steel sheet and plastic material (SG-HP).

GRAVITACIONI ZATVARAČ: SG GRAVITY SHUTTER: SG

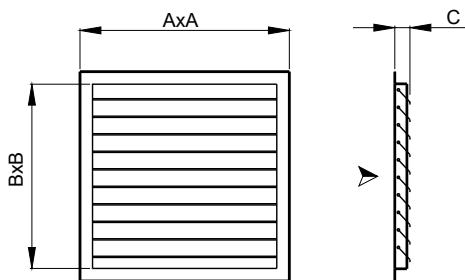

Model Model	A	B	C	kg	* V max
SG 31	370	300	35	0,6	20
SG 35	440	370	35	0,8	18
SG 40-45	510	440	35	1	15
SG 50	580	510	35	1,2	13
SG 56	650	580	35	1,6	11
SG 63	720	650	35	2,6	9
SG 71	785	715	35	3	8,7

GRAVITACIONI ZATVARAČ SG-HP GRAVITY SHUTTER: SG-HP

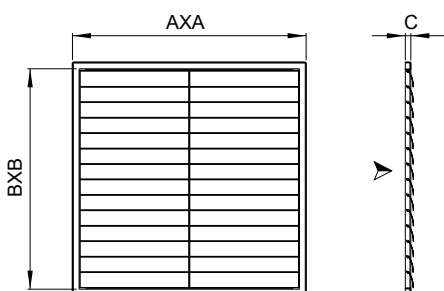

Model Model	A	B	C	kg	* V max
SG-HP 63	720	650	35	3,2	25
SG-HP 71	785	715	35	3,6	22
SG-HP 80	920	850	25	6,8	19
SG-HP 90	960	900	25	9	19
SG-HP 100	1060	1000	25	11	17
SG-HP 112	1230	1140	25	16	15
SG-HP 125	1365	1275	25	19	13

* Pažnja: ne prekoračujte naznačenu brzinu vazduha (m/s)

* Attention: don't exceed the indicated air speed (m/s)

RING

PRIBOR - ACCESSORIES

SKUARE PANEL: SQ SQUARE PANEL: SQ

Model Model	A	B	C	D	E	F	G	H	kg
SQ 80	970	910	15	8	880		4	11	7
SQ 90	1080	1030	25	16	980	830	12	11	13
SQ 100	1170	1120	25	16	1080	920	12	11	14
SQ 112	1360	1300	30	16	1226	1000	12	11	15
SQ 125	1440	1380	30	16	1350	1080	12	11	20
SQ 140	1700	1640	45	16	1580	1100	12	16	35
SQ 160	1920	1860	45	24	1810	1200	12	16	50

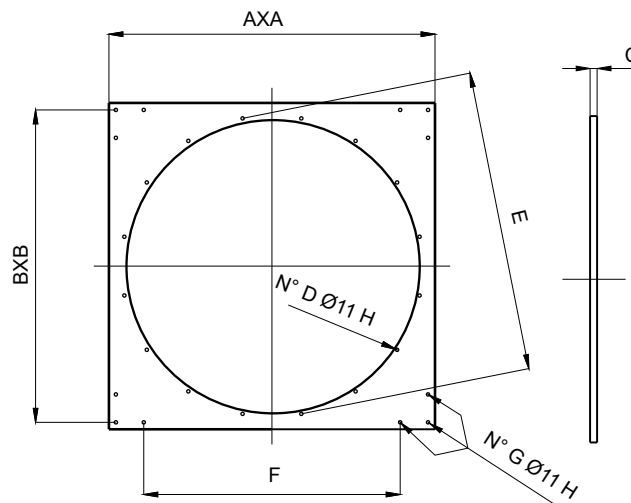

FIKSIRANJE STOPALA: FF-RI

Omogućavaju pričvršćivanje ventilatora. Izrađen od čeličnog lima i zaštićen od atmosferskih uticaja.

FIXING FEET: FF-RI

They allow the fan fixing. Manufactured in steel sheet and protected against the atmospheric agents.

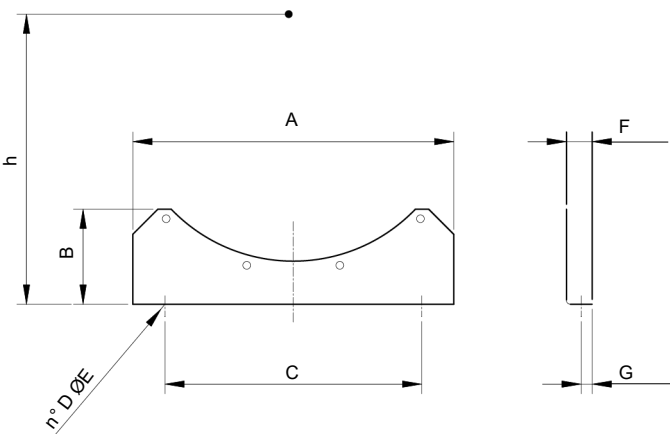

Model Model	A	B	C	D	ØE	h	F	G	kg
FF-RI 31	350	125	1x250	2	10	235	40	16	2
FF-RI 35	350	125	1x250	2	10	268	40	16	2
FF-RI 40	450	145	1x250	2	10	285	40	16	3
FF-RI 45	450	145	1x250	2	10	310	40	16	3
FF-RI 50	500	160	2x200	3	12	380	40	16	3,6
FF-RI 56	560	170	2x230	3	12	410	40	16	5
FF-RI 63	630	170	2x240	3	12	450	40	16	6
FF-RI 71	710	180	2x275	3	12	490	40	16	6,2
FF-RI 80	800	200	2x330	3	12	540	40	16	7,6
FF-RI 90	900	340	2x370	3	12	600	40	16	12
FF-RI 100	900	370	2x370	3	12	650	40	16	12,8
FF-RI 112	1120	380	2x380	3	12	710	50	20	19
FF-RI 125	1250	420	2x420	3	12	770	50	20	21,2
FF-RI 140	1400	360	3x400	4	16	870	70	25	37,6
FF-RI 160	1600	470	3x500	4	20	980	70	25	44